

- **Einstellbare Mehrspindelköpfe mit 2 Spindeln**
- ▲ **Adjustable multiple spindle heads with 2 spindles**
- **Têtes multibroches réglables avec 2 broches**

MH 20



● Technische Daten		▲ Technical Data		■ Caractéristiques techniques	
Bohrleistung	2,5–16 mm / 600 N/mm ²	Drilling capacity	2,5–16 mm / 600 N/mm ²	Capacité de perçage	2,5–16 mm / 600 N/mm ²
Verstellbereich	9–157,5 mm	Adjustment range	9–157,5 mm	Limite de réglage	9–157,5 mm
Drehzahlbereich	3000–6000 min ⁻¹	Speed range	3000–6000 min ⁻¹	Vitesse de rotation	3000–6000 min ⁻¹
Präzisionsspannzange	S 1502 / ER 8–25	Precision collets	S 1502 / ER 8–25	Pincés de précision	S 1502 / ER 8–25
Stellhülzenspindel	DIN 55058	Automotive spindle	DIN 55058	Broche pour douilles réglable	DIN 55058
Übersetzung	1:1	Gear ratio	1:1	Rapport	1:1
Ölbadschmierung	Schauglas	Oil bath lubrication	Oil level sight glass	Lubrification bain d'huile	Voyant d'huile

● Mehrspindelköpfe ohne Adapter		● Inklusive Adapter für Suhner-Bearbeitungseinheiten				▲ Including adapters to fit Suhner machining units				■ Avec adaptateur pour les Suhner unités d'usinage					
▲ Multispindle heads without adapter		BEM 6 BEM 6 D BEW 6		BEM 12 BEM 12 D BEW 12		BEM 20–125 GEM 20 C BEA 25 CNC		BEM 28 ISO 40		BEX 15 ER 25		BEX 35 ISO 40		GEM 12	
Typ	Best.-Nr.	Typ	Best.-Nr.	Typ	Best.-Nr.	Typ	Best.-Nr.	Typ	Best.-Nr.	Typ	Best.-Nr.	Typ	Best.-Nr.	Typ	Best.-Nr.
Type	Order No.	Type	Order No.	Type	Order No.	Type	Order No.	Type	Order No.	Type	Order No.	Type	Order No.	Type	Order No.
MH 20/5	140 107	MH 20/5-6	52 017 02 K = 106	MH 20/5-12	50 763 01 K = 108	MH 20/5-20	50 780 01 K = 80,5	MH 20/5-28	58 720 02 K = 142	—	—	—	—	MH 20/5-12	52 965 03 K = 111
MH 20/7	140 108	MH 20/7-6	52 017 03 K = 106	MH 20/7-12	50 763 02 K = 108	MH 20/7-20	50 780 02 K = 80,5	MH 20/7-28	58 720 03 K = 142	MH 20/7-15	59 517 01 K = 66	—	—	MH 20/7-12	52 965 04 K = 111
MH 20/10	140 109	—	—	—	—	MH 20/10-20	50 781 01 K = 82,6	MH 20/10-28	58 720 04 K = 144	MH 20/10-15	59 517 02 K = 68	MH 20/10-35	50 783 01 K = 85	—	—
MH 20/13	140 110	—	—	—	—	MH 20/13-20	50 781 02 K = 82,6	MH 20/13-28	58 720 05 K = 144	MH 20/13-15	59 517 03 K = 68	MH 20/13-35	50 783 02	—	—

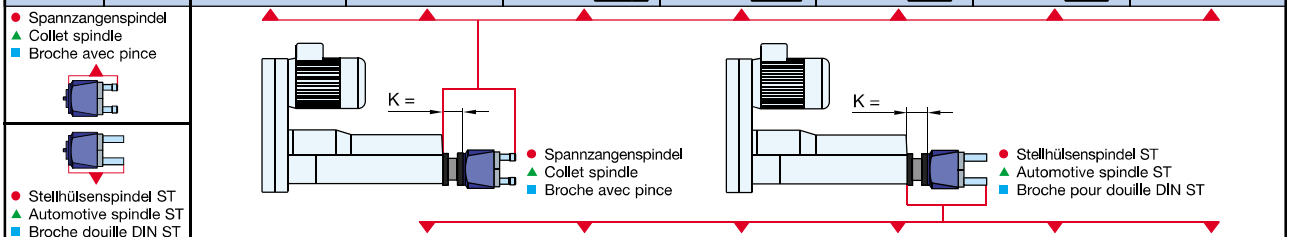

● Spannzangenspindel		▲ Collet spindle		■ Broche avec pince		● Stellhülzenspindel ST		▲ Automotive spindle ST		■ Broche douille DIN ST			
MH 20/7 ST	58 721 01	—	—	MH 20/7-12 ST	50 763 20 K = 108	MH 20/7-20 ST	50 780 20 K = 80,5	MH 20/7-28 ST	58 720 20 K = 142	—	—	MH 20/7-16 ST	52 965 20 K = 111
MH 20/10 ST	58 721 02	—	—	—	—	MH 20/10-20 ST	50 781 20 K = 82,6	MH 20/10-28 ST	58 720 21 K = 144	MH 20/10-15 ST	59 517 05 K = 68	MH 20/10-35 ST	50 783 20 K = 85
MH 20/13 ST	58 721 03	—	—	—	—	MH 20/13-20 ST	50 781 21 K = 82,6	MH 20/13-28 ST	58 720 22 K = 144	MH 20/13-15 ST	59 517 06 K = 68	MH 20/13-35 ST	50 783 21 K = 85

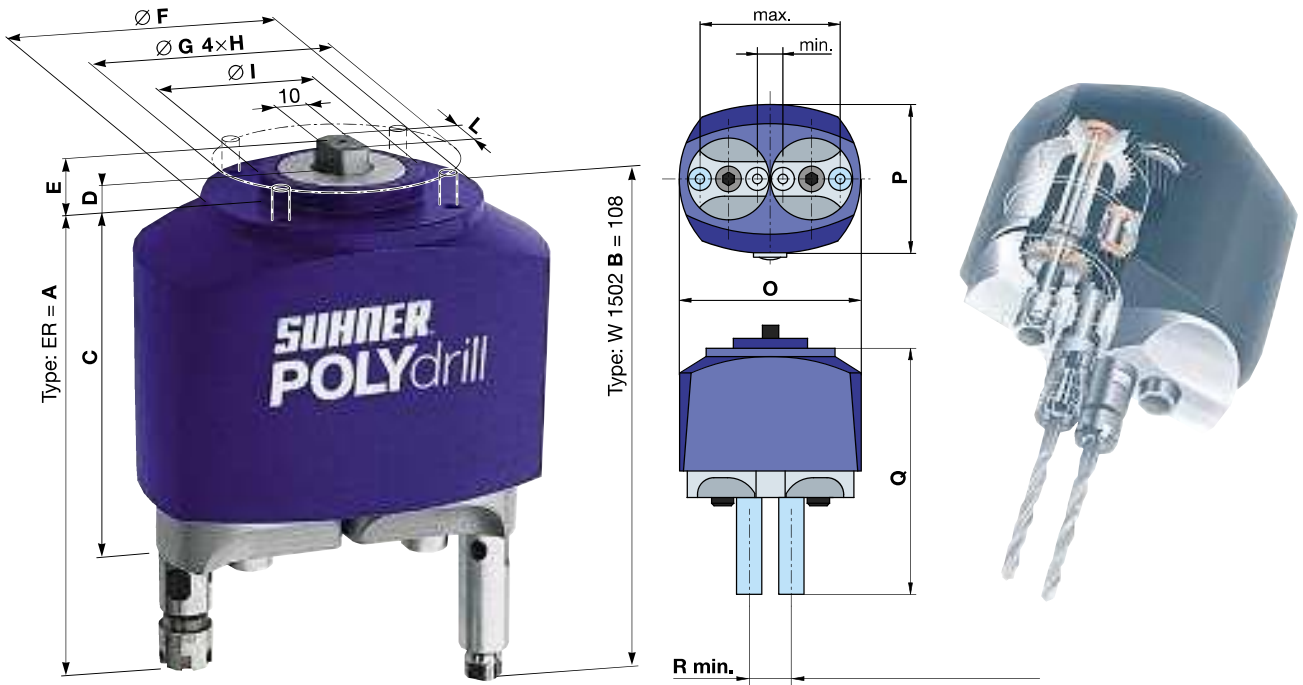

● Typ ▲ Type ■ Type	● in 600 N/mm ² ▲ in 600 N/mm ² ■ à 600 N/mm ²	● Einstellbereich ▲ Adjustment range ■ Limites de réglage min. max.	● min ⁻¹ ▲ min ⁻¹ ■ min ⁻¹	● Gewicht ▲ Weight ■ Poids	A	B	C	D	E	∅ F	∅ G	H	∅ I	∅ L	O	P	Q	min. R
MH 20/5	∅ 5,0 M 4	13,5 73,5	4000	1,4 kg	117,5	—	90,5	6	14	78	66	M 5 × 12	45	15	95	78	—	—
MH 20/7	∅ 7,0 M 6	16,0 90,0	4000	2,2 kg	136,0	—	102,0	6	14	78	66	M 5 × 14	45	17	115	78	163	19,7
MH 20/10	∅ 10,0 M 8	21,0 103,0	4000	4,0 kg	166,0	—	121,0	8	16	110	94	M 6 × 18	65	20	135	110	203	25,2
MH 20/13	∅ 13,0 M 12	27,0 129,0	3000	6,0 kg	193,0	—	139,0	8	16	110	94	M 6 × 18	65	25	166	110	229	32,2



● Längenausgleichsspindel für Gewindebohren

▲ Length compensating spindles for tapping

■ Broches à compensation pour le taraudage

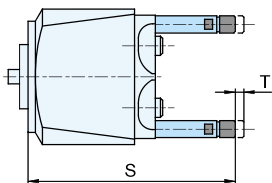

● auf Zug
▲ on extension
■ en extension

Typ / Type / Type	LAS 20/2	LAS 20/5	LAS 20/7	LAS 20/10	LAS 20/13	LAS 20/16
Best.-Nr. / Order No. / N° de cde.	59 514 01	59 514 02	59 514 03	59 514 04	59 514 05	59 514 06
Spannzange / Collet / Pince	W 1502	ER 8	ER 11	ER 16	ER 20	ER 25
S	130	150	171	200	235	267
T	5	5	9	9	10	11

G ● Werkzeugspannelemente unter dem Kapitel «G»
 ▲ Toolholder systems refer to section «G»
 ■ Éléments de serrage des outils au chapitre «G»

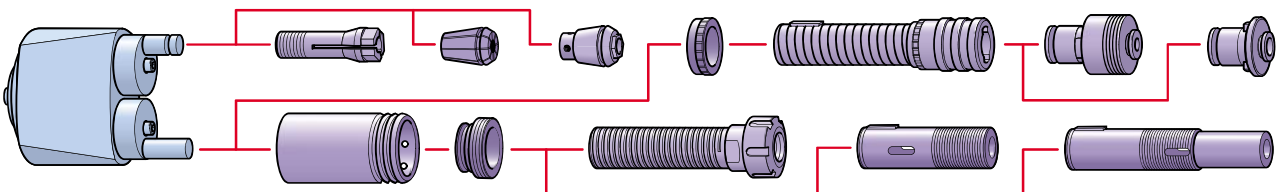

F ● Aufbaukomponenten unter dem Kapitel «F», Seite F 18
 ▲ Assembly components refer to section «F», page F 18
 ■ Composants d'implantation au chapitre «F», page F 18

